

THE INFORMATION CONTAINED IN THIS DRAWING IS THE SOLE PROPERTY OF ALTIMATE MEDICAL. ANY REPRODUCTION IN PART OR WHOLE WITHOUT THE WRITTEN PERMISSION OF ALTIMATE MEDICAL IS PROHIBITED.

NOTE:
1. APPLY LABELS SYMMETRICALLY ON BOTH SIDES.

| REVISIONS | | | | |
|-----------|--|------------|----------|-----------|
| REV: | DESCRIPTION: | ECO #: | DATE: | APPROVED: |
| 000 | NEW RELEASE. | 05-ECO-001 | 7/12/05 | JVS |
| A | REPLACED 600065 & 600066 WITH 600184 & 600053 | 05-ECO-021 | 11/10/05 | JVS |
| B | REPLACED 600028 AND 600027 WITH 600213, 600108, AND 600009 | 06-ECO-006 | 3/2/06 | GJR |
| C | REPLACED #92901 WITH #600262 | DCR-00075 | 10/19/06 | JVS |
| D | REPLACED NG10000 WITH NG10526, NG10003 WITH NG10385, | 06-ECO-051 | 11/20/06 | MWL |
| D | REPLACED NG40003 WITH NG40015. ADDED ITEM 600131. | - | - | - |
| D | REMOVED ITEMS NG10008, NG20046, 600085, NG10393, 600262. | - | - | - |
| E | REVISED NG10385 TO REVISION A. | DCR-00111 | 1/11/07 | MWL |
| F | REVISED NG10385 TO REVISION B. | DCR-00183 | 5/27/04 | MWL |
| G | ADDED WARNING STICKERS 80890. | DCR-00459 | 10/27/08 | MWL |
| H | REMOVED NG50100 FROM THIS BILL OF MATERIALS. | DCR-00613 | 10/29/09 | MWL |
| I | REPLACED 600392 WITH 600274 AND 600011 | DCR-00715 | 10/6/10 | TJF |
| J | SWITCHED #80890 WITH Y4001, NEW PINCH STICKER | DCR-00919 | 4/30/12 | JVS |

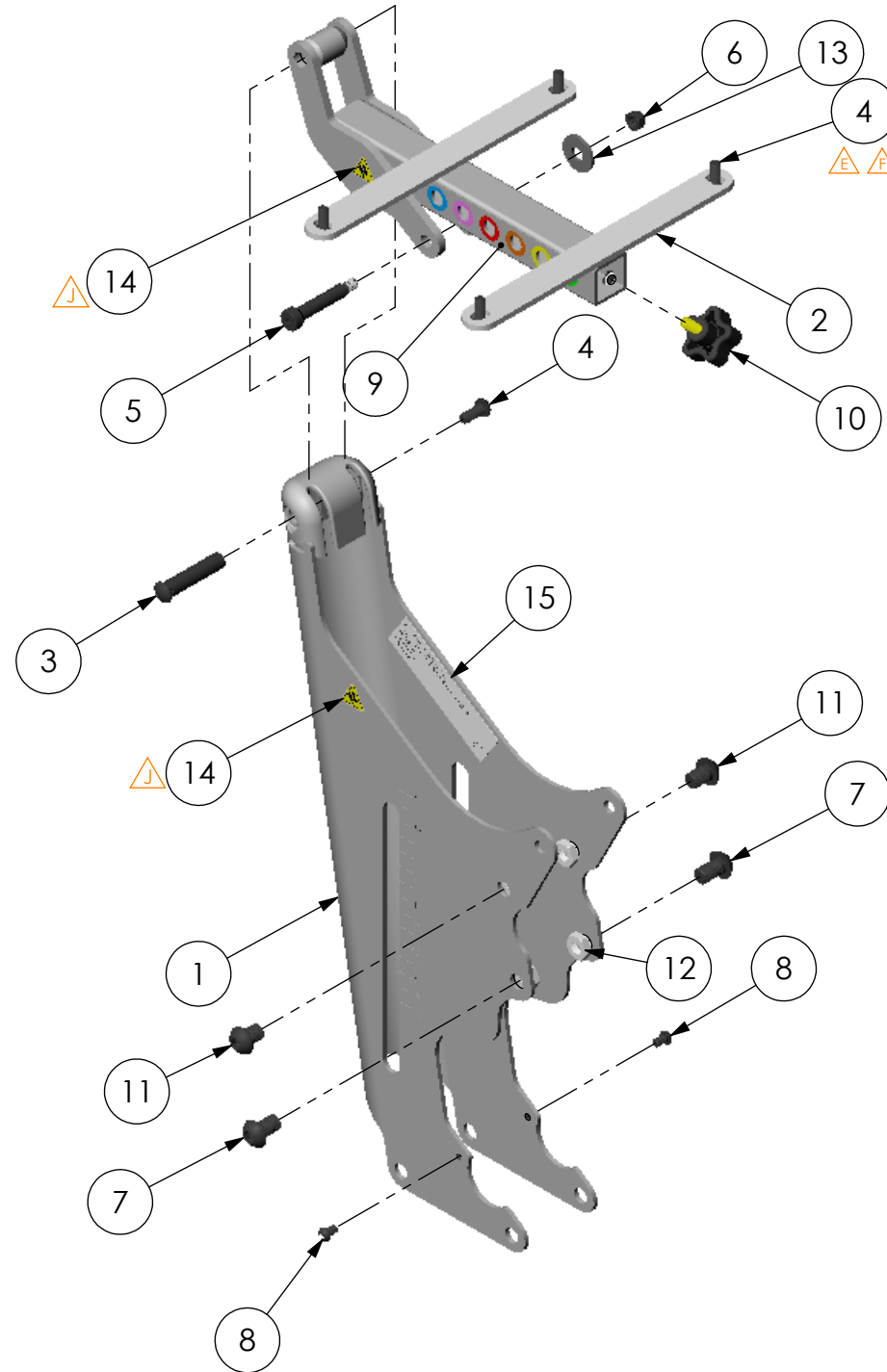

| ITEM NO. | PART NO. | REV | QTY. | NAME |
|----------|----------|-----|------|--|
| 1 | NG10526 | 000 | 1 | WELDMENT SEAT POST |
| 2 | NG10385 | B | 1 | BRACKET SEAT PIVOT |
| 3 | 600184 | 000 | 1 | BOLT SEX M8-1.25 X .472 X 2.141 BARREL |
| 4 | 600053 | 000 | 5 | BOLT M8 X 20 BTN SHCS |
| 5 | 600213 | 000 | 1 | BOLT SHOULDER M10 X 45 |
| 6 | 600009 | 000 | 1 | NUT M8 X 1.25 NYLON LOCK |
| 7 | 600020 | 000 | 2 | M12 X 1.75 - 20 BTN SHCS |
| 8 | 600037 | 000 | 2 | BOLT BTNHD M6 X 1.0-10 |
| 9 | NG40015 | 000 | 1 | LABEL SEAT DEPTH |
| 10 | 600131 | 000 | 1 | KNOB MALE 5 POINT M8 X 1.25 - 16 |
| 11 | 600148 | 000 | 2 | BOLT M12 X 1.75 - 16 BTN SHCS |
| 12 | 600059 | 000 | 4 | NUT JAM M12 X 1.75 |
| 13 | 600108 | 000 | 1 | WASHER M10 REGULAR |
| 14 | Y4001 | 000 | 4 | LABEL HAND CRUSH |
| 15 | 10765 | A | 1 | SERIAL USA/CE NUMBER LABEL |

| | | | | | |
|---|------------------|---------------|---|--|--------------|
| IF BOX CONTAINS AN "X", SEE NOTES THAT APPLY TO EACH SUBJECT. <input type="checkbox"/> SEE SHIPPING INSTRUCTIONS <input type="checkbox"/> RECEIVING INSPECTION <input type="checkbox"/> SEE ENVIRONMENTAL INSTRUCTIONS | APPROVED: | DATE: | UNLESS OTHERWISE SPECIFIED DIMENSIONS ARE IN INCHES. TOLERANCES AND SPECS. ARE: DECIMALS ANGLES .X ± .1 .X ± .5° .XX ± .03 .XXX ± .015 HOLE SIZE TOLERANCE: (+.005/-.000) BREAK EDGES .005 - .015 CMFR DRILLED HOLES .03 X 45° | ALTIMATE MEDICAL, INC. PO BOX 180 - 262 WEST FIRST STREET - MORTON, MN 56270 PHONE (507) 697-6393 FAX (507) 697-6900 DESCRIPTION: SEAT LIFT W/ ARMS MED SIZE DWG. NO. NG50007 REV. J SCALE = 1:5 CAD FILE NAME: NG50007 SHEET 1 OF 1 | |
| | DRAWN: MWL | DATE: 1/10/06 | | | MATERIAL: |
| | OPTION NUMBER: - | FINISH: - | | | CODE: ASMBLY |
| | | | | | |