

THE INFORMATION CONTAINED IN THIS DRAWING IS THE SOLE PROPERTY OF ALTIMATE MEDICAL. ANY REPRODUCTION IN PART OR WHOLE WITHOUT THE WRITTEN PERMISSION OF ALTIMATE MEDICAL IS PROHIBITED.

REVISIONS				
REV:	DESCRIPTION:	ECO #:	DATE:	APPROVED:
000	NEW RELEASE.	05-ECO-001	7/12/05	JVS

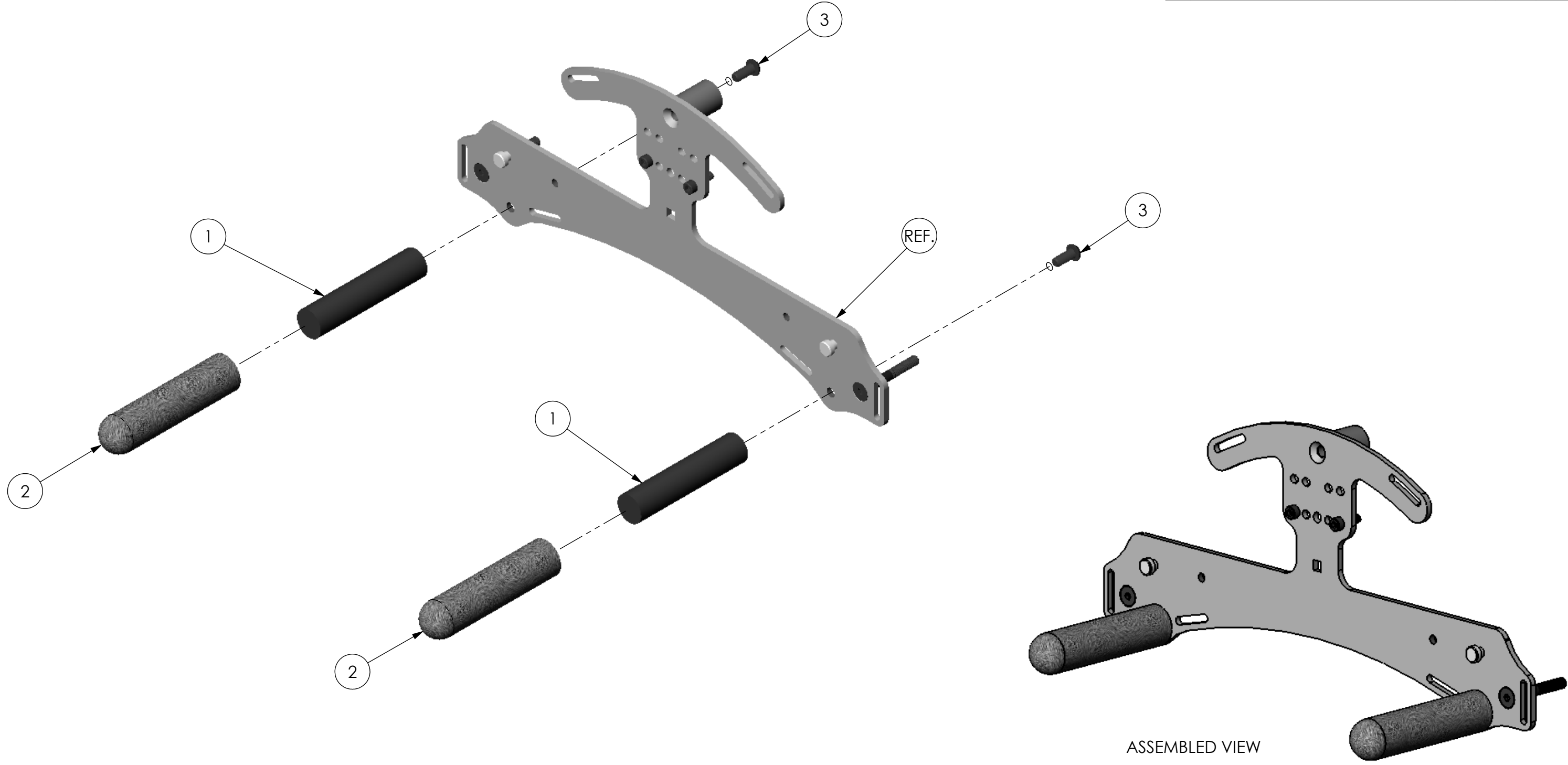

ASSEMBLED VIEW

ITEM NO.	PART NO.	REV	Default/ QTY.	NAME
1	ng20051	000	2	SHAFT SUPPORT GRIP
2	600100	000	2	GRIP DIPPED FOAM 1.00 ID
3	600053	000	2	BOLT M8 X 20 BTN SHCS

IF BOX CONTAINS AN "X", SEE NOTES THAT APPLY TO EACH SUBJECT. <input type="checkbox"/> SEE SHIPPING INSTRUCTIONS <input type="checkbox"/> RECEIVING INSPECTION <input type="checkbox"/> SEE ENVIRONMENTAL INSTRUCTIONS	APPROVED:	DATE:	UNLESS OTHERWISE SPECIFIED DIMENSIONS ARE IN INCHES. TOLERANCES AND SPECS. ARE: DECIMALS ANGLES .X ± .1 .X ± .5° .XX ± .03 .XXX ± .015 HOLE SIZE TOLERANCE: (+.005/ -.000) BREAK EDGES .005 - .015 CMFR DRILLED HOLES .03 X 45°	ALTIMATE MEDICAL, INC. PO BOX 180 - 262 WEST FIRST STREET - MORTON, MN 56270 PHONE (507) 697-6393 FAX (507) 697-6900 DESCRIPTION: HANDLE PUSH ASSEMBLY SIZE DWG. NO. NG50040 REV. 000 SCALE = 1:3 CAD FILE NAME: NG50040 SHEET 1 OF 1	
	DRAWN: MWL	DATE: 3/2/05			MATERIAL:
	OPTION NUMBER: V916	FINISH: -			CODE: ASMBLY