

THE INFORMATION CONTAINED IN THIS DRAWING IS THE SOLE PROPERTY OF
 ALTIMATE MEDICAL. ANY REPRODUCTION IN PART OR WHOLE WITHOUT
 THE WRITTEN PERMISSION OF ALTIMATE MEDICAL IS PROHIBITED.

REVISIONS				
REV:	DESCRIPTION:	ECO #:	DATE:	APPROVED:
000	NEW RELEASE.	05-ECO-001	8/23/05	GJR
A	REPLACED NG50086 WITH NG50165.	05-ECO-051	11/21/06	MWL
B	REVISED NG50165 TO REVISION A.	DCR-00111	1/11/07	MWL
C	REVISED NG50165 TO REVISION B.	DCR-00243	8/6/07	MWL
D	REVISED NG50165 TO REVISION C.	DCR-00291	11/15/07	MWL
E	REVISED NG50165 TO REVISION D.	DCR-00395	4/23/08	MWL
F	REORGANIZED BILL OF MATERIALS.	DCR-00459	10/27/08	MWL

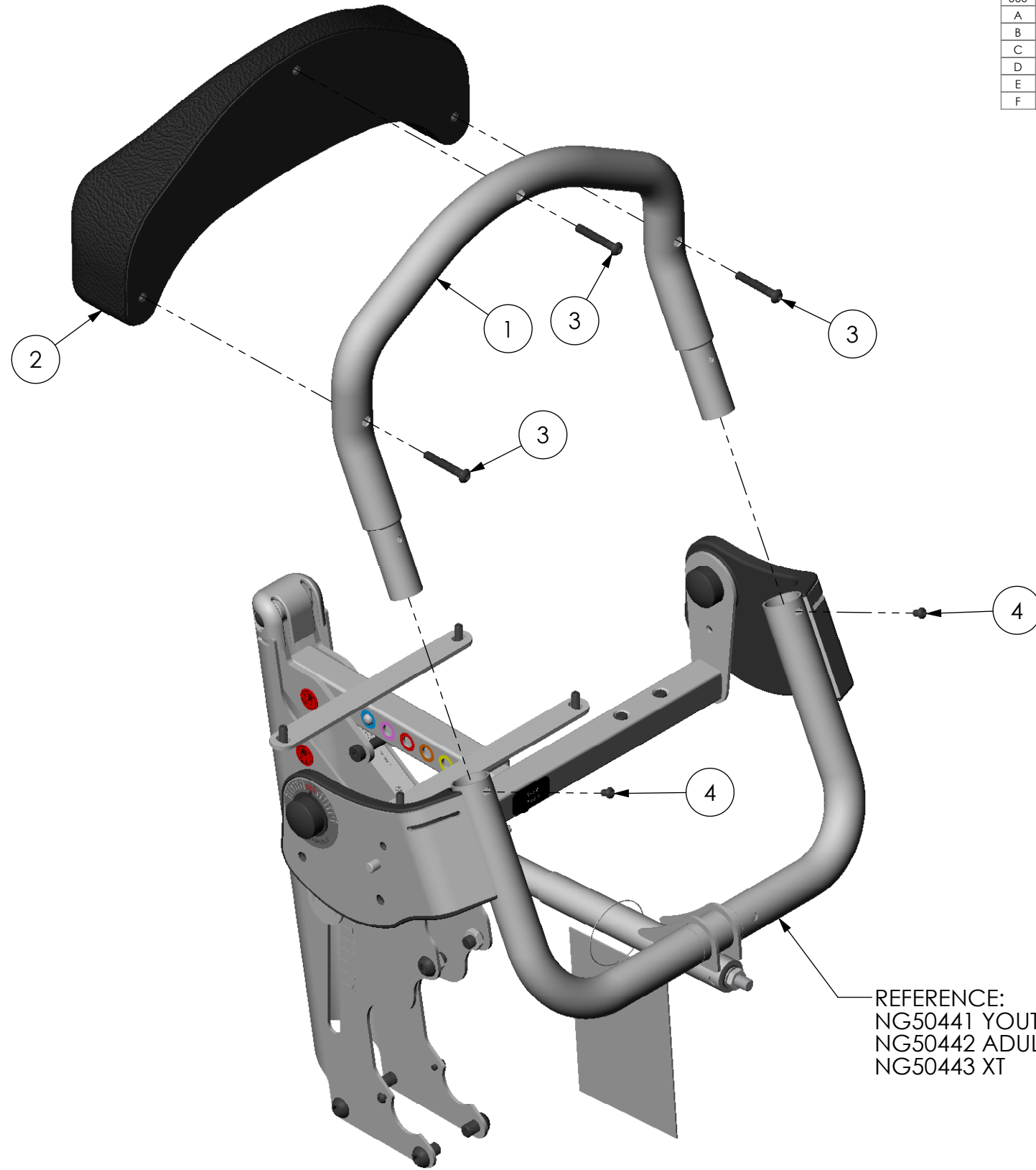

REFERENCE:
 NG50441 YOUTH
 NG50442 ADULT
 NG50443 XT

ITEM NO.	PART NO.	REV	QTY.	NAME
1	NG10273	A	1	BACK TUBE LOW
2	NG30047	A	1	PAD BACK REST CONTOURED LOW
3	600060	000	3	BOLT M8 X 1.25 X 50 BTN
4	600037	000	2	BOLT M6 X 1.0 - 10 BTN SHCS

IF BOX CONTAINS AN "X", SEE NOTES THAT APPLY TO EACH SUBJECT.

- SEE SHIPPING INSTRUCTIONS
- RECEIVING INSPECTION
- SEE ENVIRONMENTAL INSTRUCTIONS

APPROVED: _____ DATE: _____

DRAWN: JVS DATE: 4/26/2005 MATERIAL: _____
 FINISH: _____
 CODE: ASMBLY
 EXPIRATION DATE: _____

UNLESS OTHERWISE SPECIFIED
 DIMENSIONS ARE IN INCHES.
 TOLERANCES AND SPECS. ARE:
 DECIMALS .X ± .1 ANGLES .X ± .5°
 .XX ± .03
 .XXX ± .015
 HOLE SIZE TOLERANCE:
 (+.005/-.000)
 BREAK EDGES .005 - .015
 CMFR DRILLED HOLES .03 X 45°

ALTIMATE MEDICAL, INC.
 PO BOX 180 - 262 WEST FIRST STREET - MORTON, MN 56270
 PHONE (507) 697-6393 FAX (507) 697-6900
 DESCRIPTION:
 BACK LOW W/CONTOUR (V908)
 SIZE DWG. NO. **NG50062** REV. **F**
 SCALE = 1:5 CAD FILE NAME: NG50062 SHEET 1 OF 1