

THE INFORMATION CONTAINED IN THIS DRAWING IS THE SOLE PROPERTY OF  
 ALTIMATE MEDICAL. ANY REPRODUCTION IN PART OR WHOLE WITHOUT  
 THE WRITTEN PERMISSION OF ALTIMATE MEDICAL IS PROHIBITED.

REVISIONS				
REV:	DESCRIPTION:	ECO #:	DATE:	APPROVED:
000	NEW RELEASE	05-ECO-001	8/23/05	GJR
A	REPLACED NG50086 WITH NG50165.	06-ECO-051	11/21/06	MWL
B	REVISED NG50165 TO REVISION A.	DCR-00111	1/11/07	MWL
C	REVISED NG50165 TO REVISION B.	DCR-00243	8/6/07	MWL
D	REVISED NG50165 TO REVISION C.	DCR-00291	11/15/07	MWL
E	REVISED NG50165 TO REVISION D.	DCR-00395	4/23/08	MWL
F	REORGANIZED BILL OF MATERIALS.	DCR-00459	10/27/08	MWL

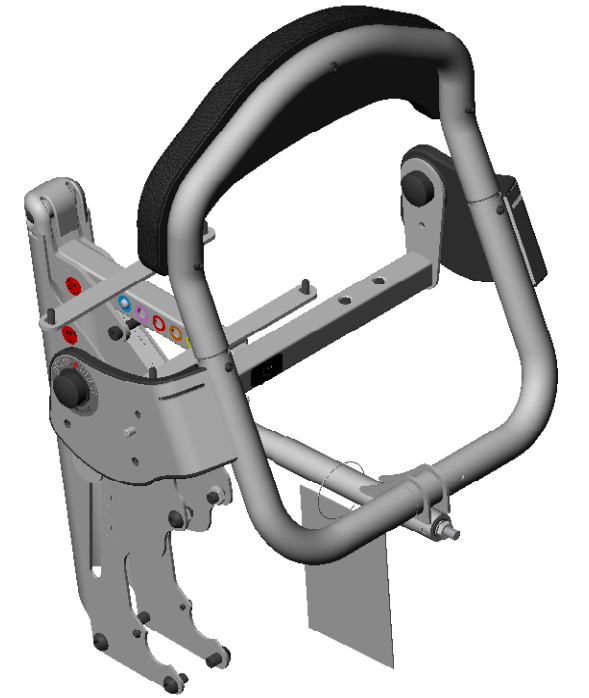
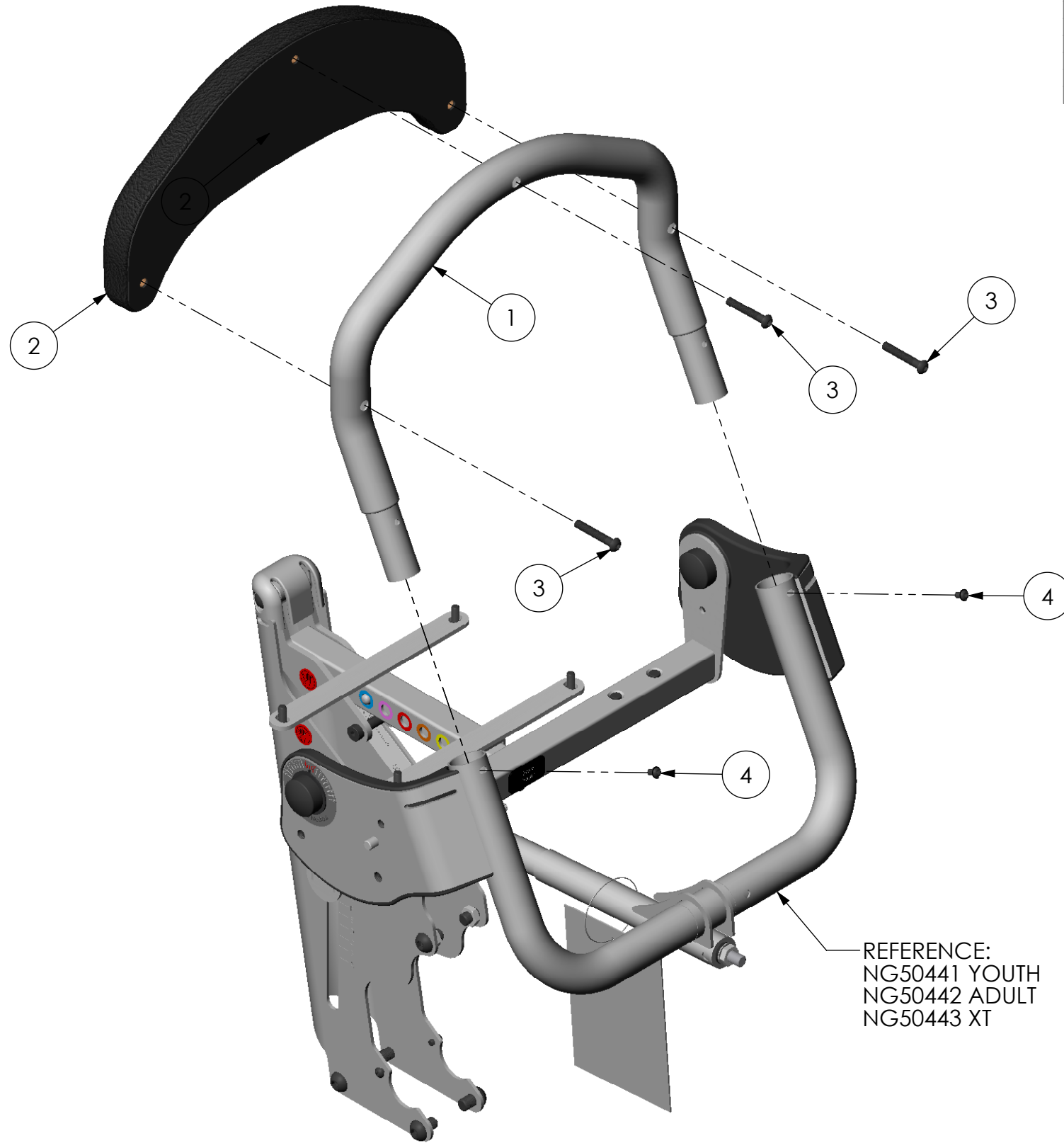

REFERENCE:  
 NG50441 YOUTH  
 NG50442 ADULT  
 NG50443 XT

ITEM NO.	PART NO.	REV	QTY.	NAME
1	NG10273	A	1	BACK TUBE LOW
2	NG30046	A	1	PAD BACK REST FLAT LOW
3	600060	000	3	BOLT M8 X 1.25 X 50 BTN
4	600037	000	2	BOLT M6 X 1.0 - 10 BTN SHCS

IF BOX CONTAINS AN "X", SEE NOTES THAT APPLY TO EACH SUBJECT.		APPROVED:		DATE:		UNLESS OTHERWISE SPECIFIED DIMENSIONS ARE IN INCHES. TOLERANCES AND SPECS. ARE:		ALTIMATE MEDICAL, INC.	
<input type="checkbox"/> SEE SHIPPING INSTRUCTIONS	<input type="checkbox"/> RECEIVING INSPECTION	<input type="checkbox"/> SEE ENVIRONMENTAL INSTRUCTIONS	DRAWN: JVS		DATE: 4/26/2005	MATERIAL:		PO BOX 180 - 262 WEST FIRST STREET - MORTON, MN 56270 PHONE (507) 697-6393 FAX (507) 697-6900	
			EXPIRATION DATE: -		FINISH: -		CODE: ASMBLY		DESCRIPTION: BACK LOW FLAT
							DECIMALS: .X ± .1 .XX ± .03 .XXX ± .015		SIZE DWG. NO. NG50066
							ANGLES: .X ± .5°		REV. F
							HOLE SIZE TOLERANCE: (+.005/- .000)		SCALE = 1:5
							BREAK EDGES .005 - .015 CMFR DRILLED HOLES .03 X 45°		CAD FILE NAME: NG50066 SHEET 1 OF 1