

THE INFORMATION CONTAINED IN THIS DRAWING IS THE SOLE PROPERTY OF ALTIMATE MEDICAL. ANY REPRODUCTION IN PART OR WHOLE WITHOUT THE WRITTEN PERMISSION OF ALTIMATE MEDICAL IS PROHIBITED.

REVISIONS				
REV:	DESCRIPTION:	ECO #:	DATE:	APPROVED:
000	NEW RELEASE.	05-ECO-001	8/23/05	GJR
A	ADDED HOLE PLUGS 600255	06-ECO-029	5-17-06	GJR
B	REPLACED NG50086 WITH NG50165.	06-ECO-051	11/21/06	MWL
C	REVISED NG50165 TO REVISION A.	DCR-00111	1/11/07	MWL
D	REVISED NG50165 TO REVISION B.	DCR-00243	8/6/07	MWL
E	REVISED NG50165 TO REVISION C.	DCR-00291	11/15/07	MWL
F	REVISED NG50165 TO REVISION D.	DCR-00395	4/23/08	MWL
G	REORGANIZED BILL OF MATERIALS.	DCR-00459	10/27/08	MWL

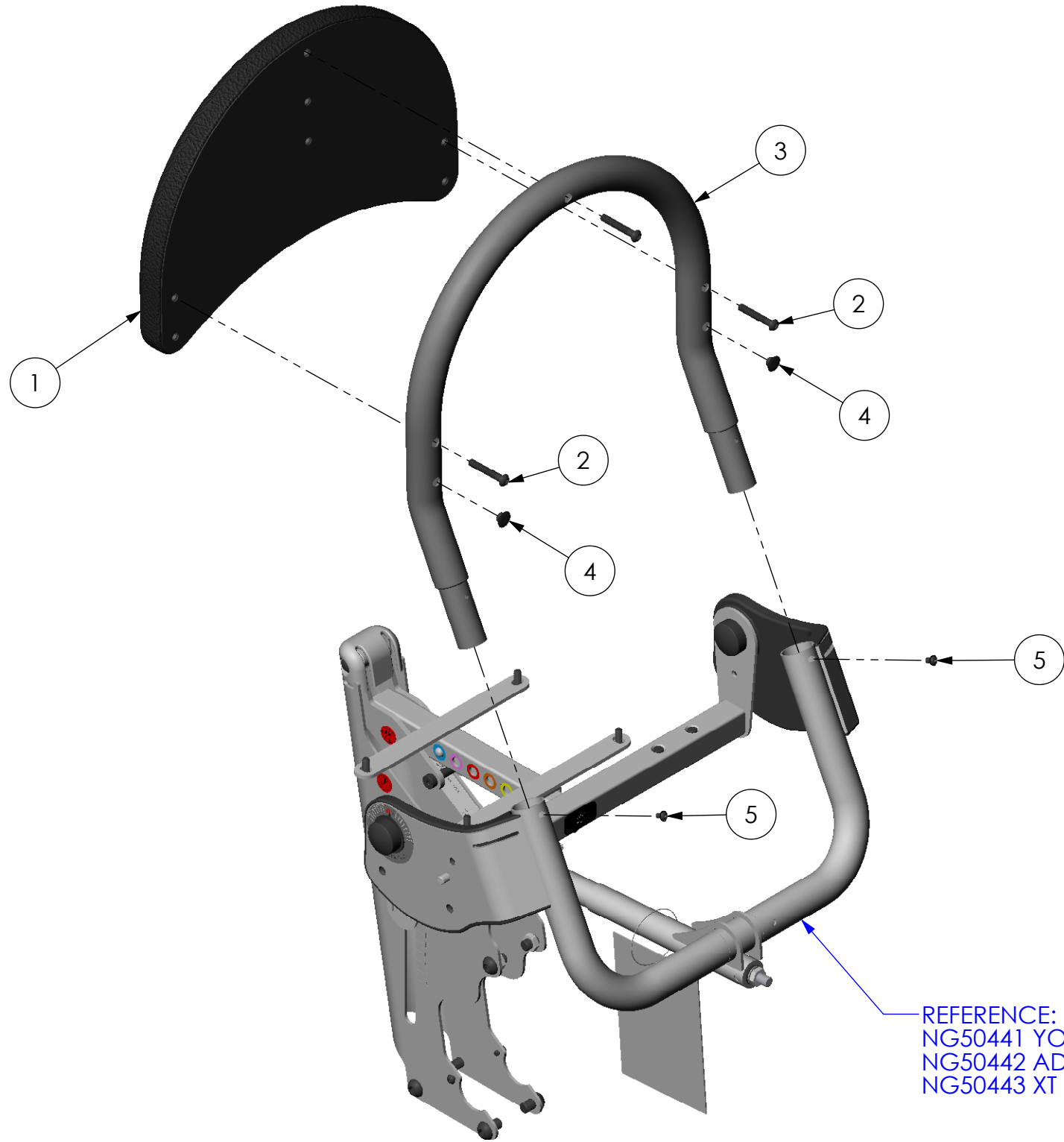

REFERENCE:
 NG50441 YOUTH
 NG50442 ADULT
 NG50443 XT

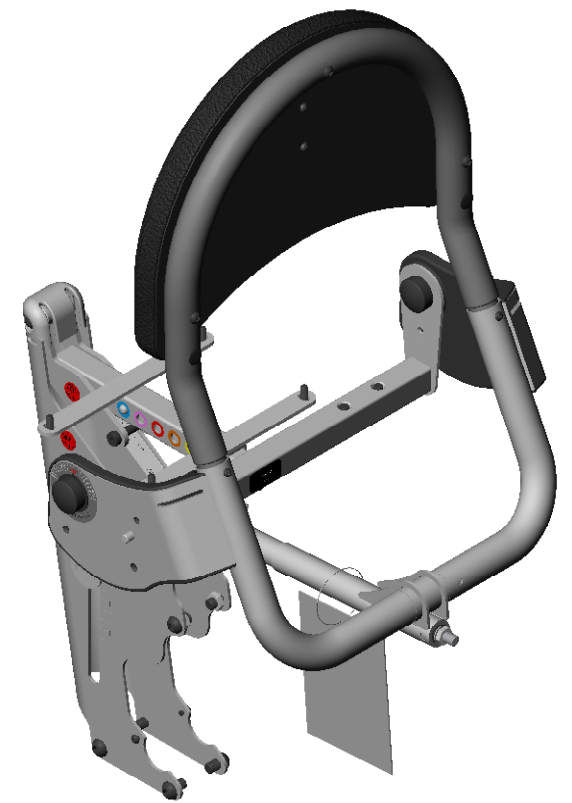

ITEM NO.	PART NO.	REV	QTY.	NAME
1	NG30048	000	1	PAD BACK REST FLAT HIGH LG
2	600060	000	3	BOLT M8 X 1.25 X 50 BTN
3	NG10057	A	1	TUBE BACK REST HIGH
4	600255	000	2	CAP END M8 FLUSH
5	600037	000	2	BOLT M6 X 1.0 - 10 BTN SHCS

IF BOX CONTAINS AN "X", SEE NOTES THAT APPLY TO EACH SUBJECT.		APPROVED:		DATE:		UNLESS OTHERWISE SPECIFIED DIMENSIONS ARE IN INCHES. TOLERANCES AND SPECS. ARE: DECIMALS: .X ± .1, .XX ± .03, .XXX ± .015 ANGLES: .X ± .5° HOLE SIZE TOLERANCE: (+.005/- .000) BREAK EDGES .005 - .015 CMFR DRILLED HOLES .03 X 45°	ALTIMATE MEDICAL, INC. PO BOX 180 - 262 WEST FIRST STREET - MORTON, MN 56270 PHONE (507) 697-6393 FAX (507) 697-6900	
<input type="checkbox"/> SEE SHIPPING INSTRUCTIONS	<input type="checkbox"/> RECEIVING INSPECTION	DRAWN: JVS	DATE: 4/26/2005	MATERIAL:			DESCRIPTION: BACK HIGH FLAT(V909)	
<input type="checkbox"/> SEE ENVIRONMENTAL INSTRUCTIONS		EXPIRATION DATE: -		FINISH: -			SIZE DWG. NO. NG50067	REV. G
				CODE: ASMBLY			SCALE = 1:6	CAD FILE NAME: NG50067 SHEET 1 OF 1