

THE INFORMATION CONTAINED IN THIS DRAWING IS THE SOLE PROPERTY OF ALTIMATE MEDICAL. ANY REPRODUCTION IN PART OR WHOLE WITHOUT THE WRITTEN PERMISSION OF ALTIMATE MEDICAL IS PROHIBITED.

REVISIONS				
REV:	DESCRIPTION:	ECO #:	DATE:	APPROVED:
000	NEW RELEASE.	06-ECO-001	1/23/06	MWL
A	REPLACED NG50086 WITH NG50165.	06-ECO-051	11/21/06	MWL
B	REVISED NG50165 TO REVISION A.	DCR-00111	1/11/07	MWL
C	REVISED NG50165 TO REVISION B.	DCR-00243	8/6/07	MWL
D	REVISED NG50165 TO REVISION C.	DCR-00291	11/15/07	MWL
E	REVISED NG50165 TO REVISION D.	DCR-00395	4/23/08	MWL
F	REORGANIZED BILL OF MATERIALS.	DCR-00459	10/27/08	MWL

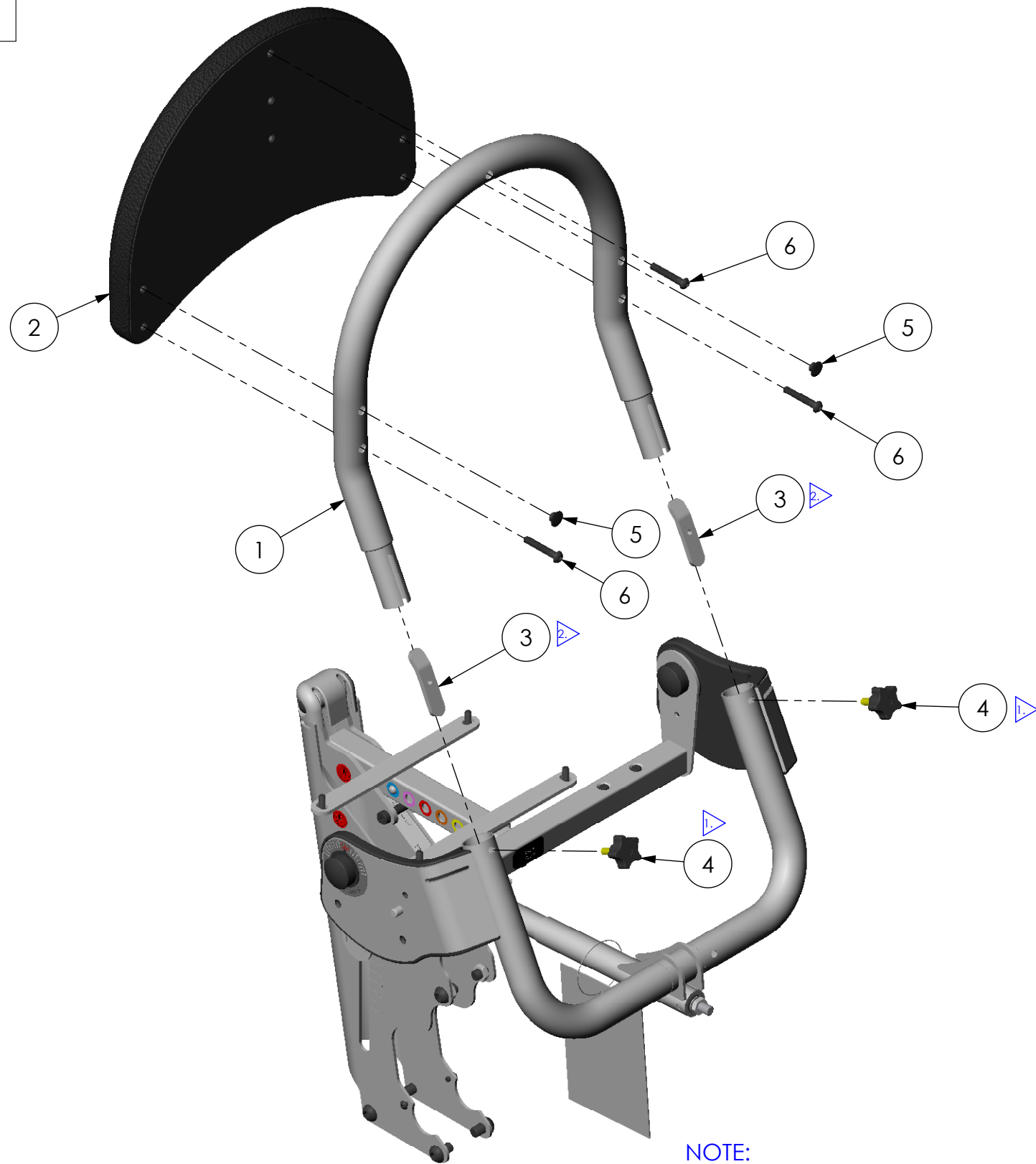

**NOTE:**  
 1. PEEN LAST THREAD OF KNOB (600054) AFTER THREADING ON TAB (NG10260).  
 2. NOTE ORIENTATION OF TAB.

ITEM NO.	PART NO.	REV	QTY.	NAME
1	NG10474	000	1	TUBE REMOVABLE BACK REST HIGH
2	NG30048	000	1	PAD BACK REST FLAT HIGH LG
3	NG10260	A	2	TAB INNER REMOVEABLE HANDLE
4	600054	000	2	KNOB M6 X 3/4 ZC 5 PT
5	600255	000	2	CAP END M8 FLUSH
6	600060	000	3	BOLT M8 X 1.25 X 50 BTN

IF BOX CONTAINS AN "X", SEE NOTES THAT APPLY TO EACH SUBJECT.		APPROVED: _____ DATE: _____		<b>UNLESS OTHERWISE SPECIFIED DIMENSIONS ARE IN INCHES. TOLERANCES AND SPECS. ARE:</b> DECIMALS      ANGLES .X ± .1          .X ± .5° .XX ± .03 .XXX ± .015 HOLE SIZE TOLERANCE: (+.005/-.000) BREAK EDGES .005 - .015 CMFR DRILLED HOLES .03 X 45°	<b>ALTIMATE MEDICAL, INC.</b> PO BOX 180 - 262 WEST FIRST STREET - MORTON, MN 56270 PHONE (507) 697-6393      FAX (507) 697-6900 DESCRIPTION: <b>BACK REMOVABLE HIGH FLAT</b> SIZE DWG. NO. <b>NG50173</b> REV. <b>F</b> SCALE = 1:6      CAD FILE NAME: NG50173      SHEET 1 OF 1
<input type="checkbox"/> SEE SHIPPING INSTRUCTIONS	<input type="checkbox"/> RECEIVING INSPECTION	DRAWN: MWL	DATE: 1/23/06		
<input type="checkbox"/> SEE ENVIRONMENTAL INSTRUCTIONS		EXPIRATION DATE: -	MATERIAL: _____		
		FINISH: -	CODE: ASMBLY		