

THE INFORMATION CONTAINED IN THIS DRAWING IS THE SOLE PROPERTY OF
 ALTIMATE MEDICAL. ANY REPRODUCTION IN PART OR WHOLE WITHOUT
 THE WRITTEN PERMISSION OF ALTIMATE MEDICAL IS PROHIBITED.

| REVISIONS | | | | |
|-----------|--------------|--------|-------|-----------|
| REV: | DESCRIPTION: | ECO #: | DATE: | APPROVED: |
| | | | | |

D
C
B
A

D
C
B
A

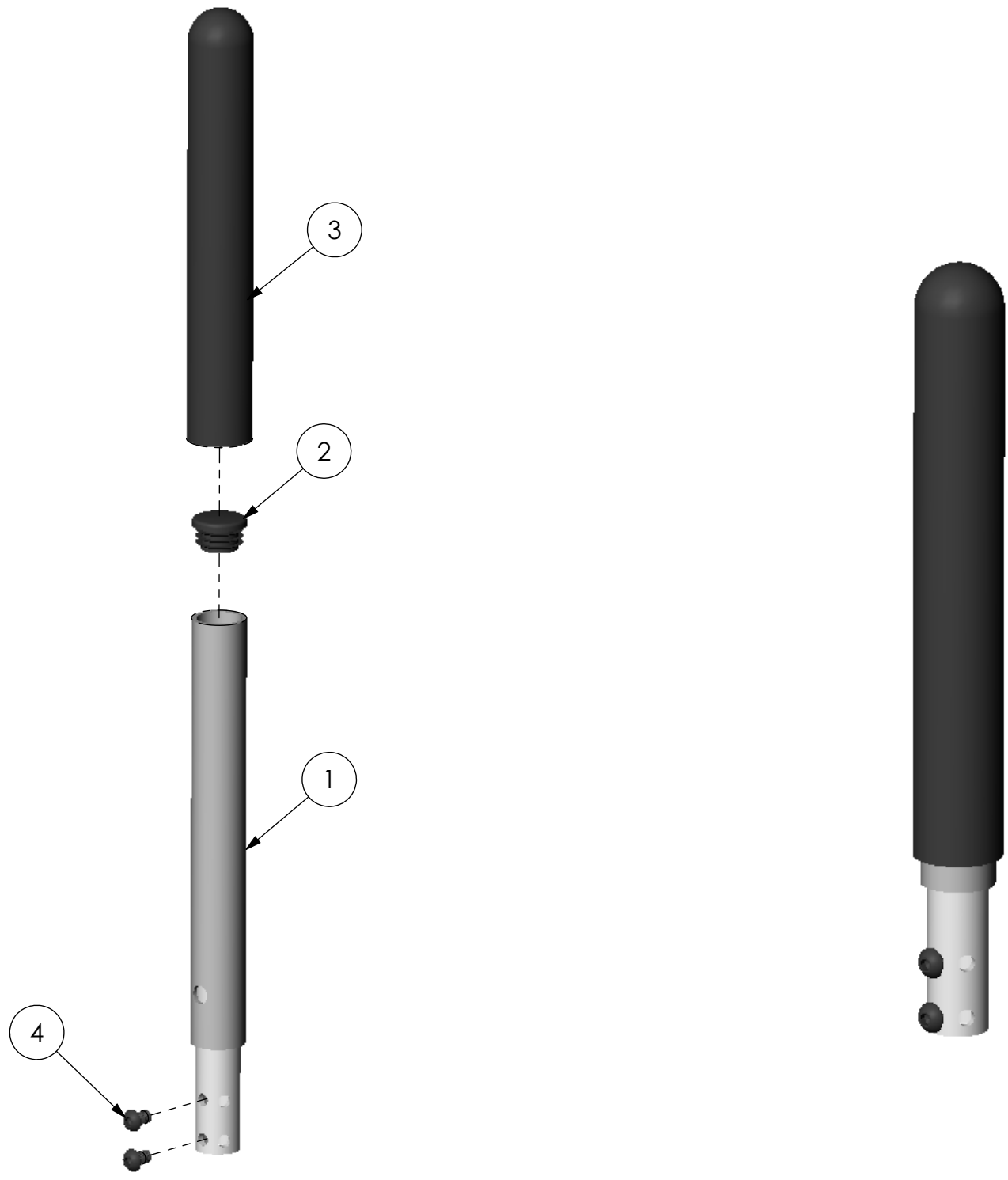

| ITEM NO. | PART NO. | REV | QTY. | NAME |
|----------|----------|-----|------|--------------------------|
| 1 | NG10301 | A | 1 | HANDLE PUMP STANDARD TOP |
| 2 | 10073 | - | 1 | CAP |
| 3 | 600061 | 000 | 1 | GRIP DIPPED FOAM 1.00 ID |
| 4 | 600037 | 000 | 2 | BOLT BTNHD M6 X 1.0-10 |

| | | | | | |
|---|---|------------------|---|--|--------------|
| IF BOX CONTAINS AN "X", SEE NOTES THAT APPLY TO EACH SUBJECT. <input type="checkbox"/> SEE SHIPPING INSTRUCTIONS <input type="checkbox"/> RECEIVING INSPECTION <input type="checkbox"/> SEE ENVIRONMENTAL INSTRUCTIONS | APPROVED: | DATE: | UNLESS OTHERWISE SPECIFIED DIMENSIONS ARE IN INCHES. TOLERANCES AND SPECS. ARE: DECIMALS: .X ± .1 .XX ± .03 .XXX ± .015 ANGLES: .X ± .5° HOLE SIZE TOLERANCE: (+.005/- .000) BREAK EDGES .005 - .015 CMFR DRILLED HOLES .03 X 45° | ALTIMATE MEDICAL, INC. PO BOX 180 - 262 WEST FIRST STREET - MORTON, MN 56270 PHONE (507) 697-6393 FAX (507) 697-6900 DESCRIPTION: HANDLE STANDARD TOP SIZE DWG. NO. NG50260 REV. 000 SCALE = 1:2.7 CAD FILE NAME: NG50260 SHEET 1 OF 1 | |
| | DRAWN: JVS | DATE: 11/15/2006 | | | MATERIAL: |
| | OPTION NUMBER: - | FINISH: - | | | CODE: ASMBLY |
| | APPROVED: _____ DATE: _____ DRAWN: JVS DATE: 11/15/2006 MATERIAL: _____ OPTION NUMBER: - FINISH: - CODE: ASMBLY | | | | |

8 7 6 5 4 3 2 1