

THE INFORMATION CONTAINED IN THIS DRAWING IS THE SOLE PROPERTY OF  
 ALTIMATE MEDICAL. ANY REPRODUCTION IN PART OR WHOLE WITHOUT  
 THE WRITTEN PERMISSION OF ALTIMATE MEDICAL IS PROHIBITED.

REVISIONS				
REV:	DESCRIPTION:	ECO #:	DATE:	APPROVED:
A	REVISED NG20010. ADDED ITEMS 80103 AND 600220.	DCR-00646	1/26/10	MWL
B	REVISED NG10243	DCR-00935	7/6/12	TJF

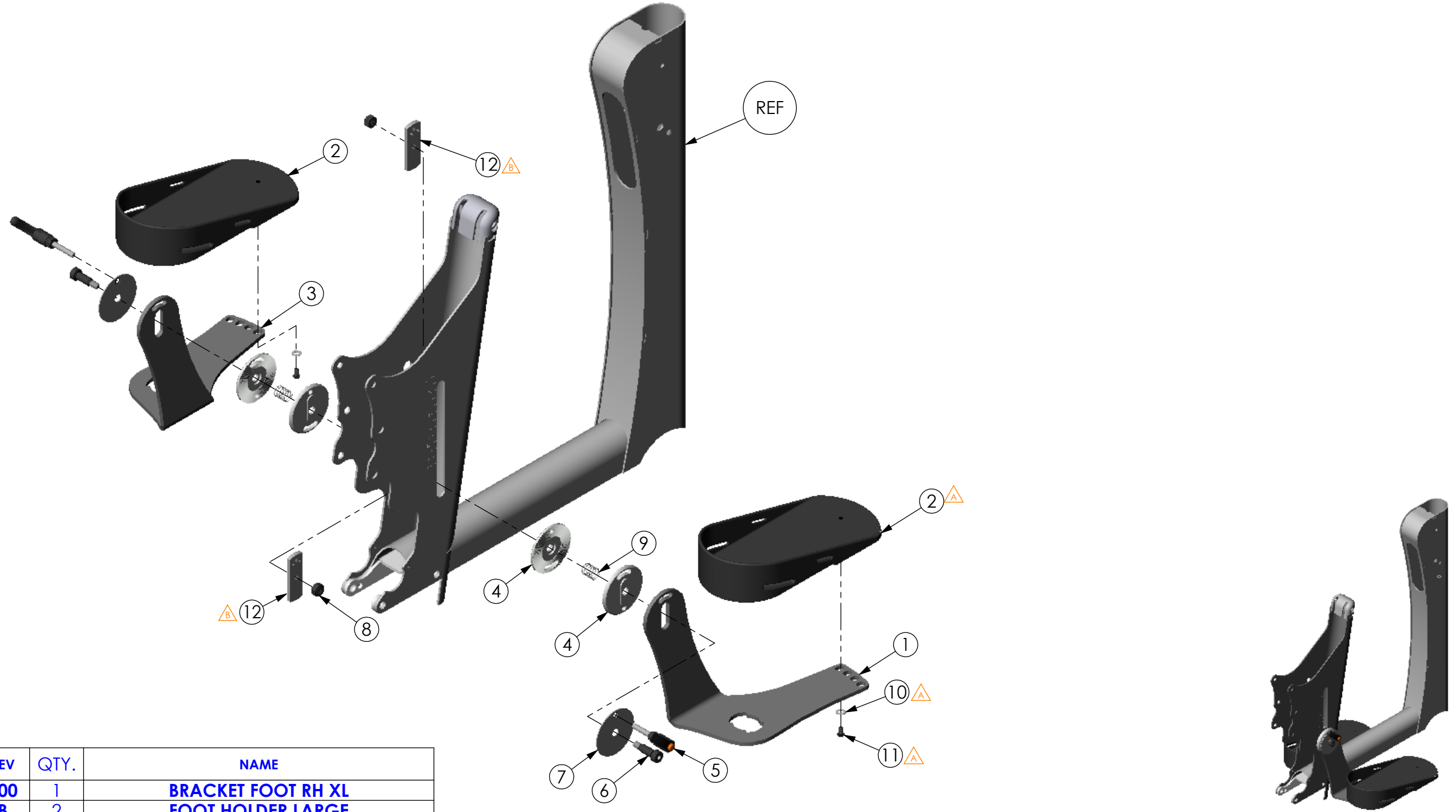

ITEM NO.	PART NO.	REV	QTY.	NAME
1	NG10694	000	1	BRACKET FOOT RH XL
2	NG20010	B	2	FOOT HOLDER LARGE
3	NG10695	000	1	BRACKET FOOT LH XL
4	NG10179	B	4	CLAMP TOOTHED
5	600156	000	2	CLAMP LEVER 8mm X 40mm
6	600114	00	2	BOLT M12 X 25 SHOULDER
7	NG10775	000	2	COVER METAL
8	600010	000	2	NUT M10 X 1.5 NYLON LOCK
9	600174	000	2	FOOT REST SPRING
10	80103	-	2	FLAT WASHER
11	600220	000	2	BOLT BTN SHCS M6 X 1.0 - 12
12	NG10243	A	2	LUG FOOT ADJUSTMENT

**NOTE:**  
 1. ASSEMBLE FOOT RESTS BEFORE INSTALLING HYDRAULIC OR ELECTRIC ACTUATOR.

IF BOX CONTAINS AN "X", SEE NOTES THAT APPLY TO EACH SUBJECT. <input type="checkbox"/> SEE SHIPPING INSTRUCTIONS <input type="checkbox"/> RECEIVING INSPECTION <input type="checkbox"/> SEE ENVIRONMENTAL INSTRUCTIONS	APPROVED:	DATE:	UNLESS OTHERWISE SPECIFIED DIMENSIONS ARE IN INCHES. TOLERANCES AND SPECS. ARE: DECIMALS      ANGLES .X ± .1          .X ± .5° .XX ± .03 .XXX ± .015 HOLE SIZE TOLERANCE: (+.005/-.000) BREAK EDGES .005 - .015 CMFR DRILLED HOLES .03 X 45°	<b>ALTIMATE MEDICAL, INC.</b> PO BOX 180 - 262 WEST FIRST STREET - MORTON, MN 56270 PHONE (507) 697-6393      FAX (507) 697-6900 DESCRIPTION: FOOT ASMBLY XT
	DRAWN: JVS	DATE: 1/10/2007		
			FINISH: -	SIZE DWG. NO. <b>NG50278</b>
			CODE: ASMBLY	REV. B
			SCALE = 1:6	CAD FILE NAME: NG50278
				SHEET 1 OF 1