

THE INFORMATION CONTAINED IN THIS DRAWING IS THE SOLE PROPERTY OF
 ALTIMATE MEDICAL. ANY REPRODUCTION IN PART OR WHOLE WITHOUT
 THE WRITTEN PERMISSION OF ALTIMATE MEDICAL IS PROHIBITED.

REVISIONS				
REV:	DESCRIPTION:	ECO #:	DATE:	APPROVED:
000	NEW RELEASE	-	-	JVS
A	REVISED NG10888 & NG10889 TO REV A	DCR-00306	12/4/07	JVS

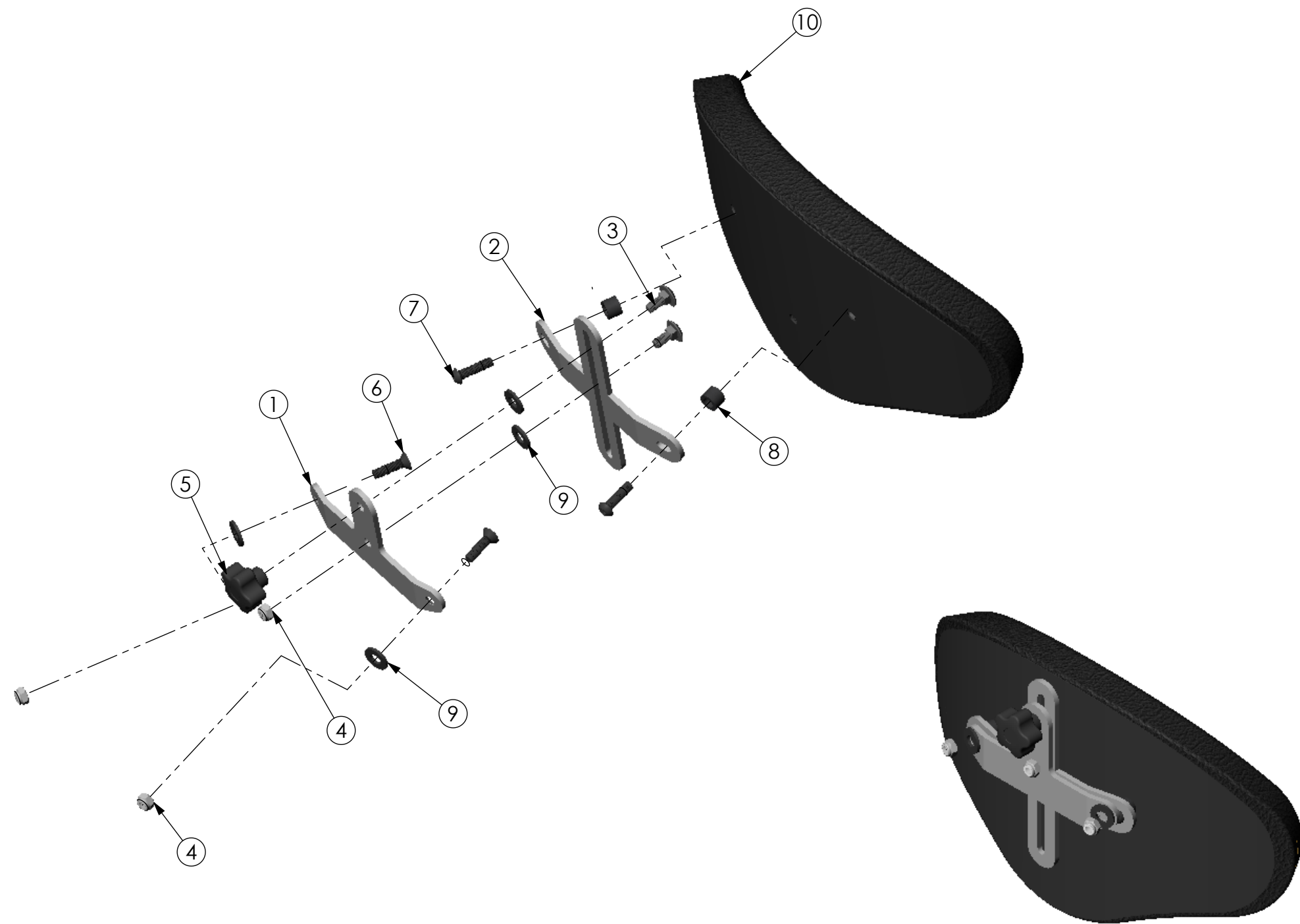

ITEM NO.	PART NO.	REV	Default/QTY.	NAME
1	NG10888	A	1	BRACKET TABLE MOUNT ADJUSTABLE
2	NG10889	A	1	BRACKET PAD MOUNT ADJUSTABLE
3	600126	000	2	BOLT M8 X 1.25 - 20 CARRIAGE
4	600009	000	3	NUT LOCK M8 X 1.25
5	600132	000	1	KNOB M8 X 1.25 5 POINT FEMALE
6	600285	000	2	BOLT M8 X 35 FCHS
7	600138	000	2	BTN SHCS M8 X 1.25-30
8	80420	A	2	SPACER BACK ADJUSTMENT TUBE YOUTH
9	600147	000	4	WASHER NYLON M10
10	NG30000	A	1	PAD FRONT EXTRA SUPPORT

IF BOX CONTAINS AN "X", SEE NOTES THAT APPLY TO EACH SUBJECT.

- SEE SHIPPING INSTRUCTIONS
- RECEIVING INSPECTION
- SEE ENVIRONMENTAL INSTRUCTIONS

APPROVED: _____ DATE: _____

DRAWN: JVS DATE: 10/4/2007 MATERIAL: _____
 FINISH: _____
 CODE: ASMBLY
 OPTION NUMBER: _____

UNLESS OTHERWISE SPECIFIED DIMENSIONS ARE IN INCHES. TOLERANCES AND SPECS. ARE:
 DECIMALS ANGLES
 .X ± .1 .X ± .5°
 .XX ± .03
 .XXX ± .015
 HOLE SIZE TOLERANCE: (+.005/- .000)
 BREAK EDGES .005 - .015
 CMFR DRILLED HOLES .03 X 45°

ALTIMATE MEDICAL, INC.
 PO BOX 180 - 262 WEST FIRST STREET - MORTON, MN 56270
 PHONE (507) 697-6393 FAX (507) 697-6900
 DESCRIPTION: ASSEMBLY ADJUSTABLE PAD BRACKET STS
 SIZE DWG. NO. **NG50331** REV. **A**
 SCALE = 1:4 CAD FILE NAME: NG50331 SHEET 1 OF 1