

THE INFORMATION CONTAINED IN THIS DRAWING IS THE SOLE PROPERTY OF
 ALTIMATE MEDICAL. ANY REPRODUCTION IN PART OR WHOLE WITHOUT
 THE WRITTEN PERMISSION OF ALTIMATE MEDICAL IS PROHIBITED.

REVISIONS				
REV:	DESCRIPTION:	ECO #:	DATE:	APPROVED:
000	NEW RELEASE.	DCR-00305	10/4/07	MWL
A	REVISED NG10992, NG10988, NG11032, NG11033, NG30245.	DCR-00330	3/6/08	MWL
A	NG30246. REMOVED NG10993, NG20086, 600337, 600010. ADDED	DCR-00330	3/6/08	MWL
A	53010, 600350, 600236, 600009, 80890 WAS QTY 6.	DCR-00330	3/6/08	MWL
B	REORGANIZED BOM TO JUST INCLUDE UPSTRY AND HDWARE.	DCR-00466	10/29/08	MWL

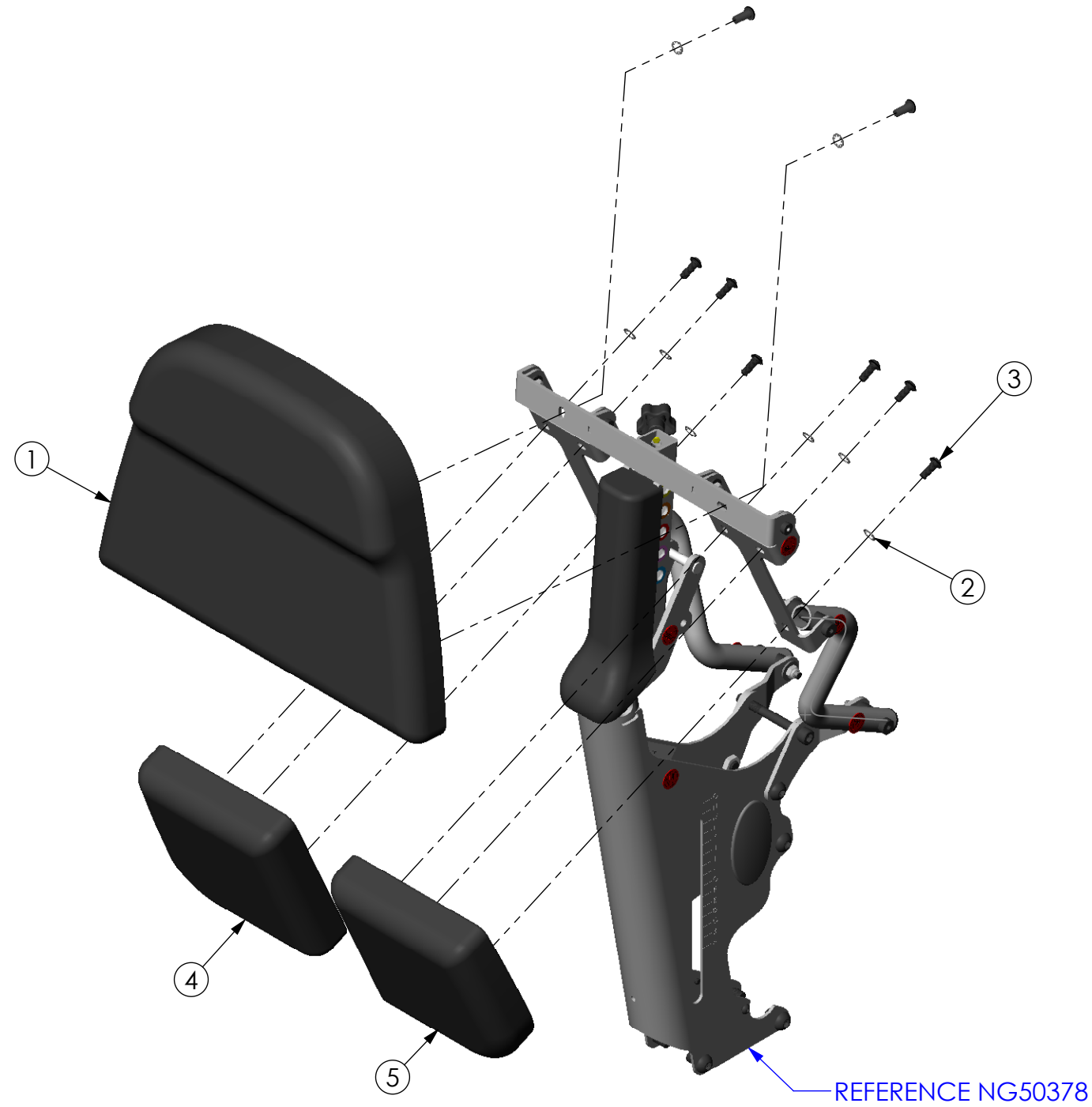

ITEM NO.	PART NO.	REV	QTY.	NAME
1	NG30253	000	1	SEAT GLIDER ADULT
2	600334	000	8	WASHER LOCK 8mm INTERNAL TOOTH
3	600053	000	8	BOLT M8 X 1.25 - 20 BTN SHCS
4	NG30245	A	1	SEAT FLAP GLIDER ADULT RH
5	NG30246	A	1	SEAT FLAP GLIDER ADULT LH

IF BOX CONTAINS AN "X", SEE NOTES THAT APPLY TO EACH SUBJECT. <input type="checkbox"/> SEE SHIPPING INSTRUCTIONS <input type="checkbox"/> RECEIVING INSPECTION <input type="checkbox"/> SEE ENVIRONMENTAL INSTRUCTIONS	APPROVED:	DATE:	UNLESS OTHERWISE SPECIFIED DIMENSIONS ARE IN INCHES. TOLERANCES AND SPECS. ARE: DECIMALS ANGLES .X ± .1 .X ± .5° .XX ± .03 .XXX ± .015 HOLE SIZE TOLERANCE: (+.005/-.000) BREAK EDGES .005 - .015 CMFR DRILLED HOLES .03 X 45°	ALTIMATE MEDICAL, INC. PO BOX 180 - 262 WEST FIRST STREET - MORTON, MN 56270 PHONE (507) 697-6393 FAX (507) 697-6900 DESCRIPTION: GLIDER SEAT ASMBLY ADULT SIZE DWG. NO. NG50352 REV. B SCALE = 1:6 CAD FILE NAME: NG50352 SHEET 1 OF 1	
	DRAWN: MWL	DATE: 11/5/07			MATERIAL:
	EXPIRATION DATE:				FINISH:
					CODE: ASMBLY