

THE INFORMATION CONTAINED IN THIS DRAWING IS THE SOLE PROPERTY OF ALTIMATE MEDICAL. ANY REPRODUCTION IN PART OR WHOLE WITHOUT THE WRITTEN PERMISSION OF ALTIMATE MEDICAL IS PROHIBITED.

REVISIONS				
REV:	DESCRIPTION:	ECO #:	DATE:	APPROVED:
000	NEW RELEASE	DCR-00310	12/19/07	MWL
A	REVISED NG10054. RESTRUCTURED BOM.	DCR-00462	11/3/08	MWL
B	REVISED NG10054 TO REV D	DCR-00591	9/08/09	JVS
C	REPLACED NG20047 WITH NG30272, REVISED NG10202 REV B	DCR-00644	1/18/10	JVS

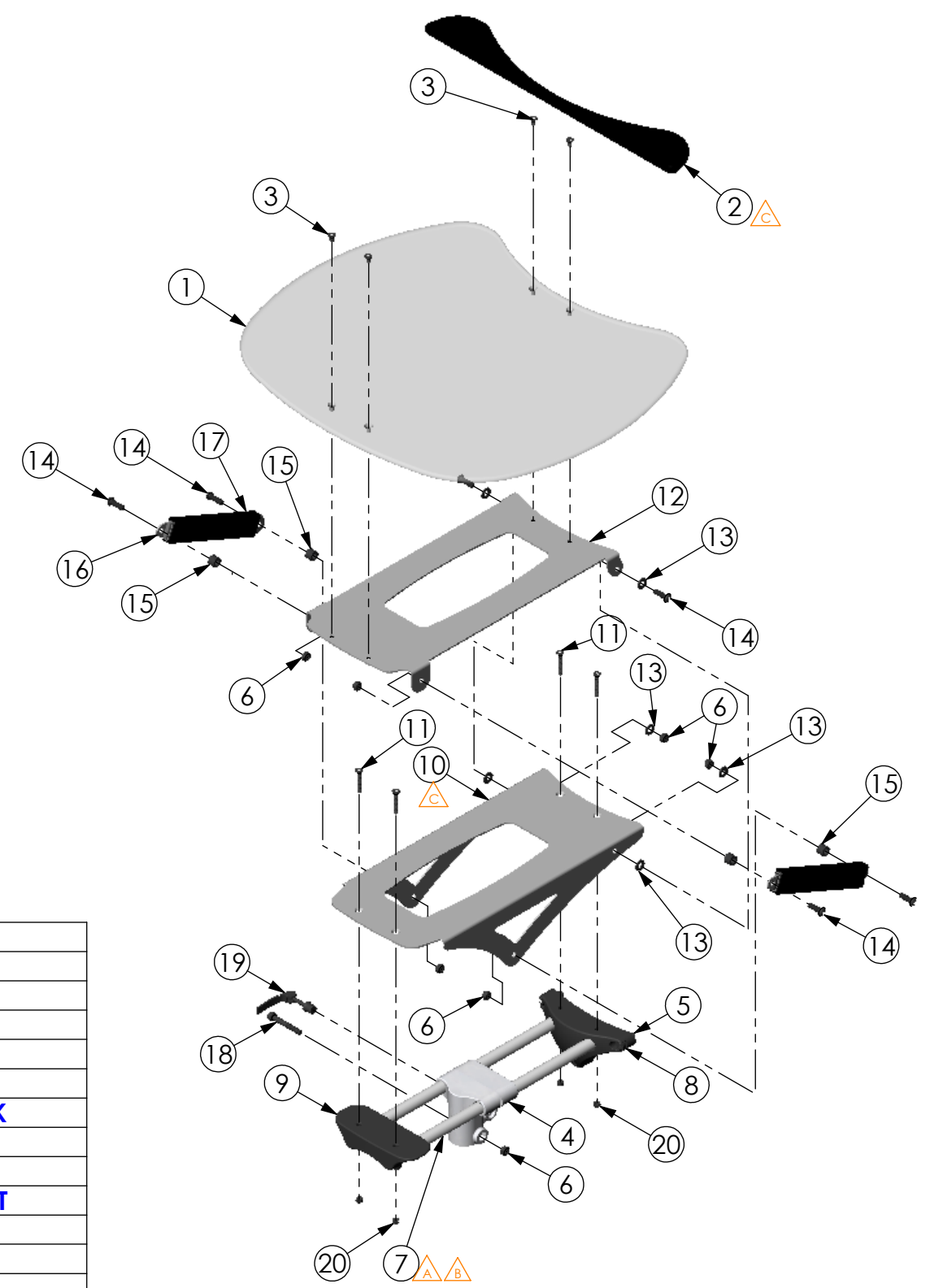

ITEM NO.	PART NO.	REV	QTY.	NAME
1	NG20017	000	1	TABLE BASIC
2	NG30272	000	1	TABLE LIP
3	600089	000	4	BOLT FLTHD M6 X 1.0-12
4	NG20004	A	1	CLAMP NYLON TABLE TOP
5	600139	000	3	BOLT SHCS M8 X 1.25-30
6	600009	000	7	NUT M8 X 1.25 NYLON LOCK
7	NG10054	D	2	TUBE TABLE ADJUSTMENT
8	NG20005	000	1	CLAMP NYLON TABLE REAR
9	NG20006	000	1	CLAMP NYLON TABLE FRONT
10	NG10202	B	1	TABLE TILT CLAMP BRACKET
11	600180	-	4	BOLT FLTHD M6 X 1.0 - 40
12	NG10203	A	1	TABLE TILT TABLE BRACKET
13	600159	000	6	WASHER NYLON M8
14	600133	000	6	BOLT M8 X 1.25 - 25 BTN SHCS
15	80420	A	4	SPACER BACK ADJUSTMENT TUBE YOUTH
16	600112	000	2	RATCHET SLIDE
17	97481	000	2	FOAM GRIP
18	600084	00	1	BOLT SHCS M8 X 1.25 - 55
19	600017	000	1	CLAMP TOGGLE LOCK M6 X 1
20	600008	000	4	NUT M6 X 1.0 NYLON LOCK

IF BOX CONTAINS AN "X", SEE NOTES THAT APPLY TO EACH SUBJECT. <input type="checkbox"/> SEE SHIPPING INSTRUCTIONS <input type="checkbox"/> RECEIVING INSPECTION <input type="checkbox"/> SEE ENVIRONMENTAL INSTRUCTIONS	APPROVED:	DATE:	UNLESS OTHERWISE SPECIFIED DIMENSIONS ARE IN INCHES. TOLERANCES AND SPECS. ARE: DECIMALS ANGLES .X ± .1 .X ± .5° .XX ± .03 .XXX ± .015 HOLE SIZE TOLERANCE: (+.005/-.000) BREAK EDGES .005 - .015 CMFR DRILLED HOLES .03 X 45°	ALTIMATE MEDICAL, INC. PO BOX 180 - 262 WEST FIRST STREET - MORTON, MN 56270 PHONE (507) 697-6393 FAX (507) 697-6900 DESCRIPTION: ASMBLY TABLE TILT CLEAR SIZE DWG. NO. NG50366 REV. C SCALE = 1:9 CAD FILE NAME: NG50366 SHEET 1 OF 1	
	DRAWN: MWL	DATE: 12/11/07			MATERIAL:
	OPTION NUMBER: -	FINISH: -			CODE: ASMBLY