

THE INFORMATION CONTAINED IN THIS DRAWING IS THE SOLE PROPERTY OF
 ALTIMATE MEDICAL. ANY REPRODUCTION IN PART OR WHOLE WITHOUT
 THE WRITTEN PERMISSION OF ALTIMATE MEDICAL IS PROHIBITED.

REVISIONS				
REV:	DESCRIPTION:	ECO #:	DATE:	APPROVED:
000	NEW RELEASE	DCR-00393	4/21/08	JVS

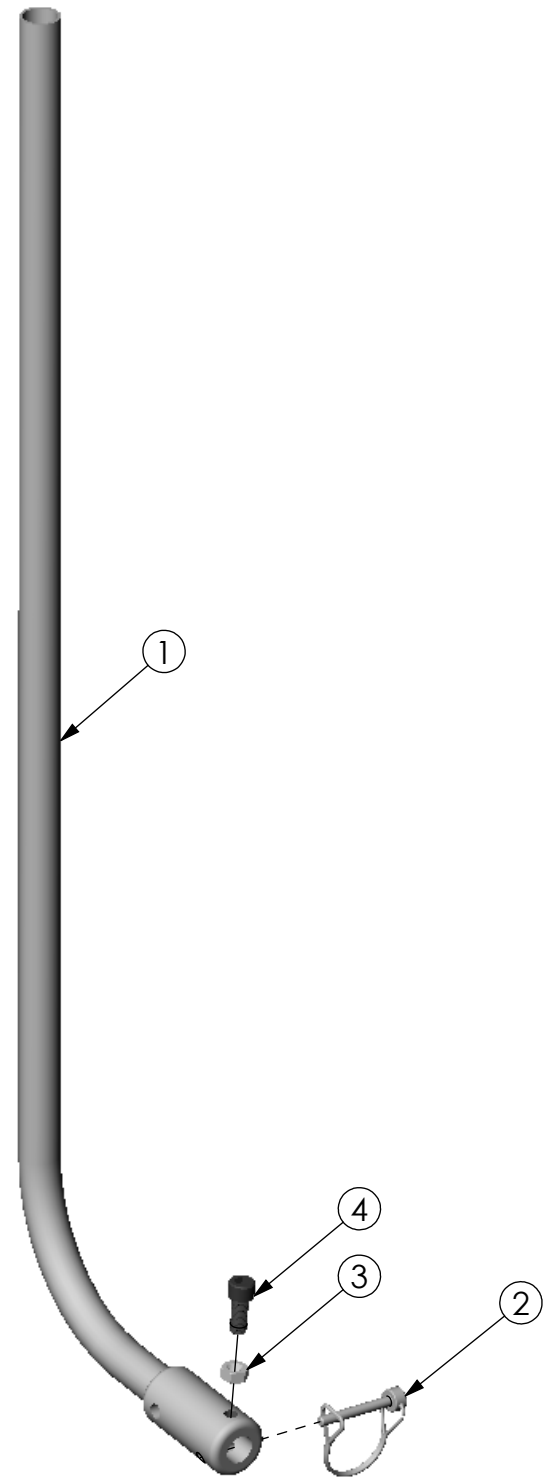

ITEM NO.	PART NO.	REV	QTY.	NAME
1	NG11082	000	1	PUMP HANDLE WELDMENT XT
2	600344	000	1	PIN STEEL LOCKING ROUND RETAINER
3	600058	000	1	NUT JAM M10 X 1.5
4	600081	00	1	BOLT M10 X 25 SHCS

IF BOX CONTAINS AN "X", SEE NOTES THAT APPLY TO EACH SUBJECT. <input type="checkbox"/> SEE SHIPPING INSTRUCTIONS <input type="checkbox"/> RECEIVING INSPECTION <input type="checkbox"/> SEE ENVIRONMENTAL INSTRUCTIONS	APPROVED:	DATE:	UNLESS OTHERWISE SPECIFIED DIMENSIONS ARE IN INCHES. TOLERANCES AND SPECS. ARE: DECIMALS ANGLES .X ± .1 .X ± .5° .XX ± .03 .XXX ± .015 HOLE SIZE TOLERANCE: (+.005/-.000) BREAK EDGES .005 - .015 CMFR DRILLED HOLES .03 X 45°	ALTIMATE MEDICAL, INC. PO BOX 180 - 262 WEST FIRST STREET - MORTON, MN 56270 PHONE (507) 697-6393 FAX (507) 697-6900		
	DRAWN:	DATE:		MATERIAL:	DESCRIPTION:	
	JVS	2/13/2008		-	PUMP HANDLE XT	
	OPTION NUMBER:	CODE:		SIZE	DWG. NO.	REV.
-			ASMBLY	-	NG50389	000
			SCALE = 1:4		CAD FILE NAME: NG50389	SHEET 1 OF 1