

THE INFORMATION CONTAINED IN THIS DRAWING IS THE SOLE PROPERTY OF
 ALTIMATE MEDICAL. ANY REPRODUCTION IN PART OR WHOLE WITHOUT
 THE WRITTEN PERMISSION OF ALTIMATE MEDICAL IS PROHIBITED.

REVISIONS				
REV:	DESCRIPTION:	ECO #:	DATE:	APPROVED:
000	NEW RELEASE.	DCR-00362	6/3/08	MWL
A	REVISED NG11132 AND NG11133 TO BRING FEET 3/4" FORWARD.	DCR-00562	6/25/09	MWL
B	REVISED NG20010. ADDED ITEMS 80103 AND 600220.	DCR-00646	1/26/10	MWL
C	REVISED NG10243	DCR-00935	7/6/12	TJF

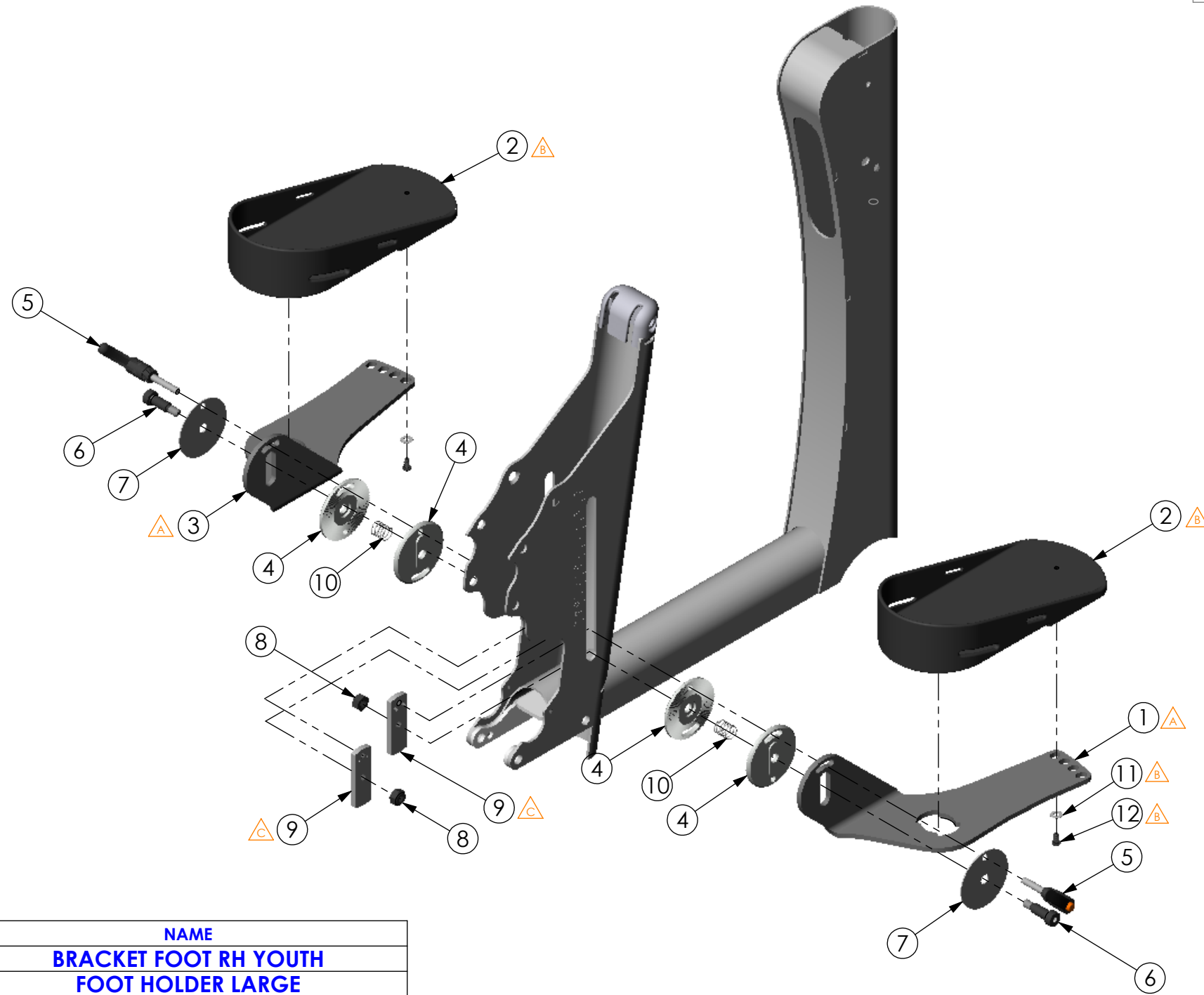

ITEM NO.	PART NO.	REV	QTY.	NAME
1	NG11132	A	1	BRACKET FOOT RH YOUTH
2	NG20010	B	2	FOOT HOLDER LARGE
3	NG11133	A	1	BRACKET FOOT LH YOUTH
4	NG10179	B	4	CLAMP TOOTHED
5	600156	000	2	CLAMP LEVER 8mm X 40mm
6	600114	000	2	BOLT M12 X 25 SHOULDER
7	NG10775	000	2	COVER METAL
8	600010	000	2	NUT M10 X 1.5 NYLON LOCK
9	NG10243	A	2	LUG FOOT ADJUSTMENT
10	600174	000	2	FOOT REST SPRING
11	80103	-	2	FLAT WASHER
12	600220	000	2	BOLT BTN SHCS M6 X 1.0 - 12

IF BOX CONTAINS AN "X", SEE NOTES THAT APPLY TO EACH SUBJECT.

- SEE SHIPPING INSTRUCTIONS
- RECEIVING INSPECTION
- SEE ENVIRONMENTAL INSTRUCTIONS

APPROVED: _____ DATE: _____

DRAWN: MWL DATE: 6/3/08 MATERIAL: _____
 FINISH: _____
 CODE: ASMBLY
 EXPIRATION DATE: _____

UNLESS OTHERWISE SPECIFIED DIMENSIONS ARE IN INCHES. TOLERANCES AND SPECS. ARE:

DECIMALS .X ± .1 ANGLES .X ± .5°
 .XX ± .03
 .XXX ± .015
 HOLE SIZE TOLERANCE: (+.005/-.000)
 BREAK EDGES .005 - .015
 CMFR DRILLED HOLES .03 X 45°

ALTIMATE MEDICAL, INC.
 PO BOX 180 - 262 WEST FIRST STREET - MORTON, MN 56270
 PHONE (507) 697-6393 FAX (507) 697-6900

DESCRIPTION: FOOT ASMBLY YOUTH

SIZE DWG. NO. **NG50414** REV. **C**
 SCALE = 1:6 CAD FILE NAME: NG50414 SHEET 1 OF 1