

THE INFORMATION CONTAINED IN THIS DRAWING IS THE SOLE PROPERTY OF
 ALTIMATE MEDICAL. ANY REPRODUCTION IN PART OR WHOLE WITHOUT
 THE WRITTEN PERMISSION OF ALTIMATE MEDICAL IS PROHIBITED.

REVISIONS				
REV:	DESCRIPTION:	ECO #:	DATE:	APPROVED:
000	NEW RELEASE	DCR-00543	6/4/09	JVS

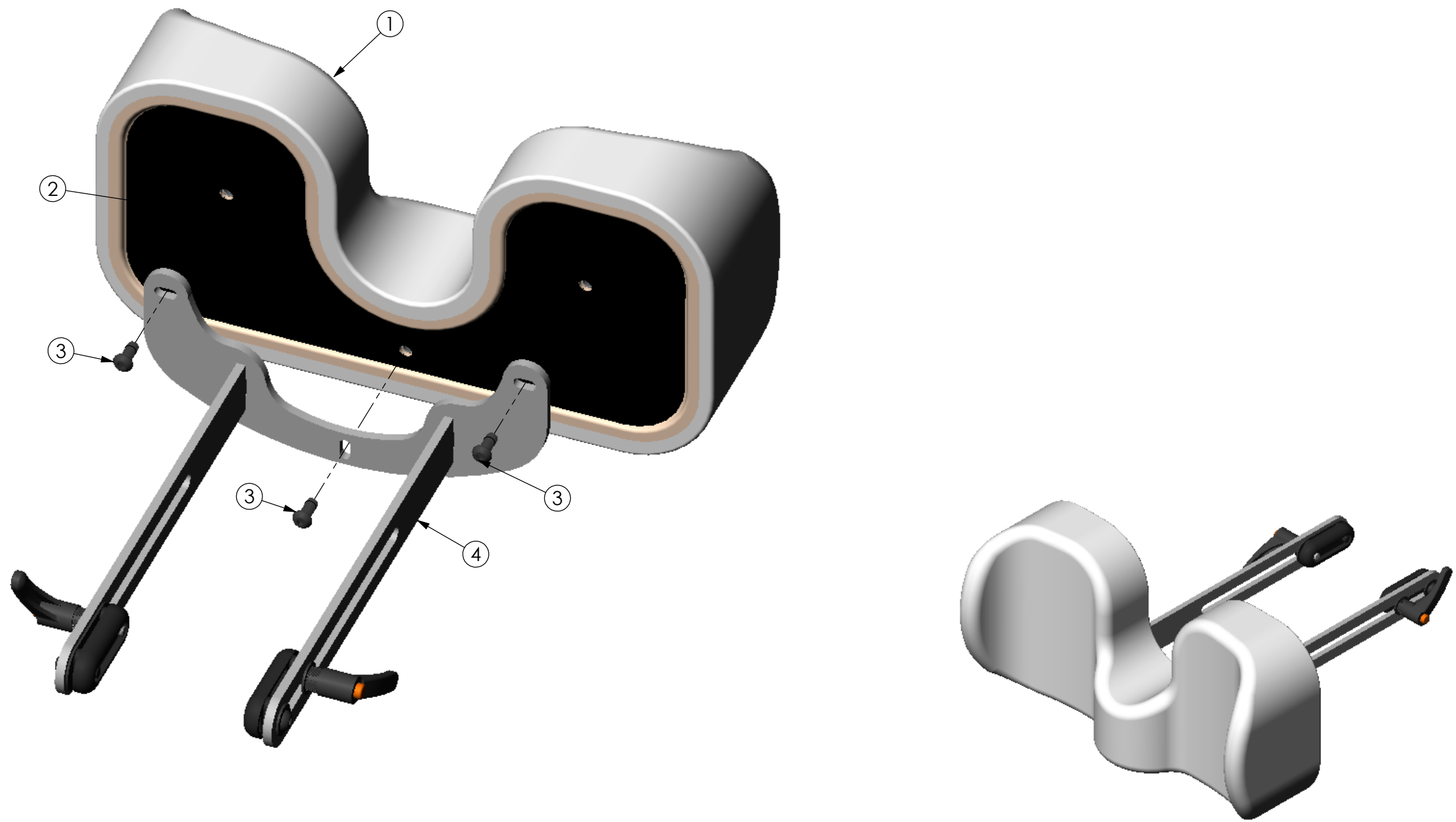

ITEM NO.	PART NO.	REV	Default /QTY.	NAME
1	NG30274	000	1	KNEE PAD ASSY EVOLV LARGE
2	NG30268	000	1	KNEE COVER BACK STANDARD LG
3	600053	000	3	BOLT M8 X 20 BTN SHCS
4	NG50422	A	1	STANDARD KNEE BRACKET ASSEMBLY

IF BOX CONTAINS AN "X", SEE NOTES THAT APPLY TO EACH SUBJECT. <input type="checkbox"/> SEE SHIPPING INSTRUCTIONS <input type="checkbox"/> RECEIVING INSPECTION <input type="checkbox"/> SEE ENVIRONMENTAL INSTRUCTIONS	APPROVED:	DATE:	UNLESS OTHERWISE SPECIFIED DIMENSIONS ARE IN INCHES. TOLERANCES AND SPECS. ARE: DECIMALS ANGLES .X ± .1 .X ± .5° .XX ± .03 .XXX ± .015 HOLE SIZE TOLERANCE: (+.005/-.000) BREAK EDGES .005 - .015 CMFR DRILLED HOLES .03 X 45°	ALTIMATE MEDICAL, INC. PO BOX 180 - 262 WEST FIRST STREET - MORTON, MN 56270 PHONE (507) 697-6393 FAX (507) 697-6900		
	DRAWN: JVS	DATE: 6/3/09		MATERIAL:	DESCRIPTION: PAD STANDARD KNEE ASSEMBLY	
	EXPIRATION DATE: -	FINISH: -		CODE: ASMBLY	SIZE DWG. NO. NG50460	REV. 000
	SCALE = 1:3			CAD FILE NAME: NG50460	SHEET 1 OF 1	